

GB



flow 2-312 M

Behind-the-Ear Hearing System (BTE)

Instructions for Use

Your Hearing Systems

Hearing healthcare professional: _____

Telephone: _____

Model: _____

Serial number: _____

Replacement batteries: Size 312

Warranty: _____

Program 1 is for: _____

Program 2 is for: _____

Program 3 is for: _____

Program 4 is for: _____

Date of purchase: _____

Quick Reference

Changing Batteries

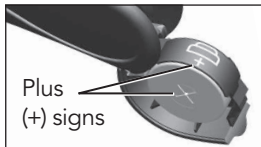

Low Battery Warning



2 beeps every 30 minutes



□ 312

On/Off

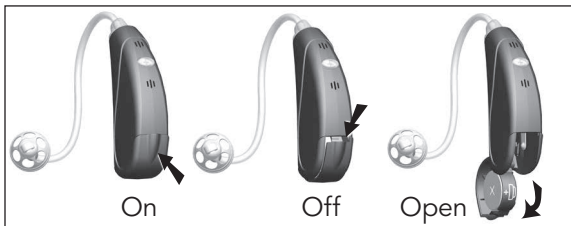

Push Button

Switching Programs

Table of Contents

Your Hearing Systems at a Glance.....	2
Warnings	4
Putting Your Hearing Systems on Your Ears.....	8
Turning Your Hearing Systems on and off	10
Battery Information	11
Tips for Wearing Hearing Systems for the First Time..	13
Operating Instructions	15
Using the Telephone	16
Protecting Your Hearing Systems.....	16
Cleaning Your Hearing Systems	17
Troubleshooting Guide	21
Warning to Hearing System Dispensers (to Comply with the U.S. Food and Drug Administration (FDA) Regulations)	26
Information and Explanation of Symbols	29
Patient Feedback.....	31
Additional Notes.....	32

Your Hearing Systems at a Glance







- 1 **Earhook** – your custom made earmold attaches to your hearing systems using the earhook
- 2 **Microphone** – sound enters your hearing systems through the microphones. **Microphone shield** – protects microphones from dirt & debris
- 3 **Push button** – switches between listening programs
- 4 **Battery door (on & off)** – close the door to turn on your hearing systems, partly open the door to turn off your hearing systems. Opening the door all the way gives you access to change the battery
- 5 **Tube** – part of the earmold that attaches it to the earhook
- 6 **Earmold** – allows the sound to pass from the hearing systems to the ear and holds the hearing systems in place
- 7 **Slim tube** – sound travels down the slim tube to the ear canal
- 8 **Retention piece** – helps prevent the dome and slim tube from moving out of the ear canal
- 9 **Dome** – holds the slim tube in place in your ear canal





Conformity to directive
93/42/EEC concerning
medical devices





Warnings



-  The intended use of hearing systems is to amplify and transmit sound to the ears and hereby compensate for impaired hearing. The hearing systems (specially programmed for each hearing loss) must only be used by the intended person. They should not be used by any other person as they could damage hearing.
-  Hearing systems should only be used as directed by your physician or hearing healthcare professional.
-  Hearing systems will not restore normal hearing and will not prevent or improve a hearing impairment resulting from organic conditions.
-  Do not use your hearing systems in explosion hazard areas.
-  Allergic reactions to hearing systems are unlikely. However, if you experience itching, redness, soreness, inflammation or a burning sensation in or around your ears, inform your hearing healthcare professional and contact your physician.
-  In the unlikely case that any parts remain in the ear canal after the removal of the hearing system, contact a physician immediately.

-  Remove your hearing systems for CT and MRI scans or for other electromagnetic procedures.
-  Special care should be exercised in wearing hearing systems when maximum sound pressure levels exceed 132 decibels. There may be a risk of impairing your remaining hearing. Speak with your hearing healthcare professional to ensure the maximum output of your hearing systems is suitable for your particular hearing loss.

Battery Warnings

-  Never leave hearing systems or batteries where small children and pets can reach them.
-  Never put hearing systems or batteries in your mouth. If a hearing system or battery is swallowed, call a physician immediately.

Precautions

-  The use of hearing systems is only part of hearing rehabilitation; auditory training and lip reading instruction may be required as well.
-  In most cases, infrequent use of hearing systems does not provide full benefit. Once you have become accustomed to your hearing systems, wear your hearing systems everyday all day.



Your hearing systems use the most modern components to provide the best possible sound quality in every listening situation. However, communication devices such as digital cell phones can create interference (a buzzing sound) in hearing systems. If you experience interference from a cell phone being used close by, you can minimize this interference in a number of ways. Switch your hearing systems to another program, turn your head in a different direction or locate the cell phone and move away from it.



This hearing system is not designed to be used for children under 36 months. The hearing system contains small parts that can cause choking if swallowed by children. Keep out of reach of pets, children and mentally challenged people. If swallowed, consult a physician or hospital immediately.



External devices may only be connected if they have been tested in accordance with corresponding IECXXXXX standards. Only use accessories approved by Hansaton, to avoid any electrical shock.

Note to Hearing Healthcare Professional



Domes should never be fitted on patients with perforated eardrums, exposed middle ear cavities, or surgically altered ear canals. In the case of such a condition, we recommend to use a customized ear mold.

Labeling

The serial number and year of manufacture are located inside the battery door.

Putting Your Hearing Systems on Your Ears

Your hearing systems may be color-coded with a small dot on the battery door: red = right ear; blue = left ear.

Hearing Systems with Earmolds

1. Hold the earmold between your thumb and index finger. The opening should be pointing in towards your ear canal with the BTE resting upwards above your ear.
2. Carefully insert the earmold in your ear. You may need to twist it slightly to the back. The earmold should fit into your ear snugly and comfortably. Gently pull down and back on your earlobe to help you insert the earmold into your ear canal more easily.
3. Place the hearing system over the top of your ear.

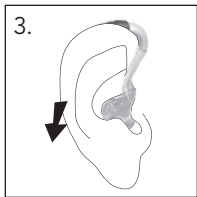
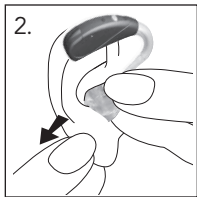
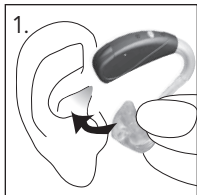

Hearing Systems with Slim Tubes

1. Place the hearing system over the top of your ear. The slim tube should lie flush against your head and not stick out.
2. Hold the slim tube where it attaches to the dome and gently push the dome into your ear canal.
3. Place the retention piece in your ear so it rests at the bottom of the opening of your ear canal.

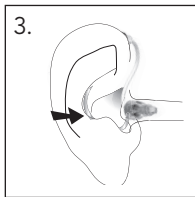
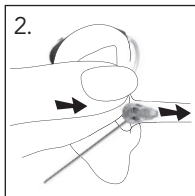
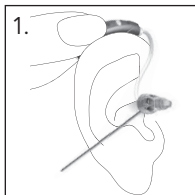

Turning Your Hearing Systems on and off

Your hearing systems have a three-position battery door that acts as an on/off switch and that allows access to the battery compartment.

1. **On:** Close the battery door fully.

 *Note: It may take 5 seconds before the hearing system turns on. Your hearing healthcare provider can increase the start up delay if required.*

2. **Off:** Partially open the battery door.
3. **Open:** Fully open the battery door to access and change the battery.

 *Note: When turning your hearing system on and off while it is on the ear, grasp the top and bottom of the device with your index finger and thumb. Use your thumb to open and close the battery door.*



Battery Information

To replace the battery, fully open the battery door for access to the battery compartment.

Low Battery Warning

Two long beeps indicate the hearing system battery is low. After the low battery warning, sounds may not be as clear. This is normal and can be fixed by changing the batteries in the hearing systems.

If you are not able to hear the low battery warning, your hearing healthcare professional can change its pitch or loudness. If you prefer, it can be turned off entirely.

 *Your hearing systems are designed to generate a low battery warning every 30 minutes until you change the batteries, but depending on the condition of the batteries, they may die before another low battery warning occurs. Therefore, it is recommended that the batteries are replaced as soon as possible once you hear the low battery warning.*

Replacing the Battery

1. Gently swing out the battery door with your fingernail.
2. Grasp the battery with your thumb and index finger and remove.
3. Insert the new battery into the battery compartment with the plus (+) sign on the battery facing the same way as the plus (+) sign on the side of the battery door. This will ensure that the battery door closes properly.

 *Note: If the battery is inserted incorrectly, the hearing system will not turn on.*

4. Close the battery door.



Caring for Batteries

Always discard batteries in a safe and environmentally friendly way.

To prolong battery life, remember to turn your hearing systems off when not in use, especially when asleep.

Remove the batteries and keep the battery door open while hearing systems are not being worn, especially when asleep. This will allow internal moisture to evaporate.

Tips for Wearing Hearing Systems for the First Time

- Start in a quiet room at home first to get used to the new sound quality. Sounds like the ticking of a clock, the humming of the computer, the beep of the microwave or the rustling of clothes or paper may seem loud to you at first, because you have not been hearing them properly for a long time.
- Read aloud to yourself and learn to adjust the volume of your own voice when you are wearing the hearing systems.
- Talk to different people and learn how to distinguish between different sound patterns again.

- It will take some time before you are completely used to your hearing systems and can fully enjoy the benefits.
- Wear your hearing systems for as many hours a day as you can, and for a little longer each day.
- Make notes at the back of this booklet, write down difficult situations and describe what any unpleasant noises were like. This information will help your hearing healthcare professional to fine-tune the hearing systems better for your needs.
- Involve your family and friends in this familiarization period. For example, ask someone to set the television to a comfortable volume.
- When you are beginning to get used to wearing the hearing systems, wear them in more difficult listening environments such as the office, at parties or in restaurants. This can be difficult even for people who can hear normally. Give yourself time to regain your ability to hear in these difficult situations.
- Make your hearing systems part of your everyday life and be patient with yourself while you are learning to hear sounds correctly.

Operating Instructions

Your hearing systems come with a push button that allows you to further adjust them.

Push Button - Program Control



Your hearing systems are equipped with a push button which can be used to switch between programs. Each time you push the button, you will move to a new hearing system program.

Your hearing systems beep to indicate which program you are in.

Program 1 (e.g. AutoMic)	♪	1 beep
Program 2 (e.g. speech in noise)	♪♪	2 beeps
Program 3 (e.g. telephone)	♪♪♪	3 beeps
Program 4 (e.g. music)	♪♪♪♪	4 beeps

Please see the front of this booklet for a listing of your personalized programs.

Using the Telephone

As telephones do not all work the same, you may experience different results from different phones. You can use many phones by simply holding the receiver to your ear, without the need to change to a dedicated telephone program on your hearing system. You may need to move the handset slightly up or back to find the position that sounds best to you.

Depending on the phone type you use, your hearing healthcare professional might have selected a dedicated phone program on your hearing systems.

Protecting Your Hearing Systems

- Open the battery door when not in use.
- Always remove your hearing systems when using hair care products. The hearing systems can become clogged and cease to function properly.
- Do not wear your hearing systems in the bath or shower or immerse them in water.
- If your hearing systems do become wet, do not attempt to dry them in an oven or microwave. Do not adjust any controls. Open the battery doors immediately, and allow your hearing systems to dry naturally for 24 hours.

- Protect your hearing systems from excessive heat (hair dryer, vehicle glove box or dashboard).
- Regular use of a dehumidifier, such as a Dri-Aid kit, can help prevent corrosion and prolong the life of your hearing systems.
- Do not drop your hearing systems or knock them against hard surfaces.

Cleaning Your Hearing Systems

Use a soft cloth to clean your hearing system at the end of each day, and place it in its case with the battery door open to allow moisture to evaporate.

 *Ear wax is natural and common. Ensuring your hearing systems are free of ear wax is an important step in your daily cleaning and maintenance routine.*

 *Never use alcohol to clean your hearing systems, earmolds or domes.*

 *Do not use sharp tools to dislodge ear wax. Sticking household items into your hearing systems or earmolds can seriously damage them.*

Cleaning Your Earmolds

Clean the earmold and the outside of the earhook with a damp cloth at the end of each day.

 *Do not use alcohol to clean your earmolds.*



If the earmolds become plugged, clear the opening with a wax loop or pipe cleaner.

If your physician prescribes eardrops, clean any moisture that may get into the earmolds or tubing to prevent plugging.

If the earmolds require further cleaning:

1. Disconnect the plastic tube from the hook of the hearing system, by holding the hearing system in one hand and gently pulling the tubing away from the earhook.
2. Wash only the earmolds and tubing in warm water with a mild soap.
3. Rinse them with cool water and dry overnight.
4. Make sure the earmold tubes are completely dry. Reconnect them to the earhook on your hearing system by sliding the tubing back on to the earhook. Use of a hearing system blower can assist with removing moisture/debris from the tube. See

your hearing healthcare professional for more information.

Cleaning Your Slim Tubes and Domes

You should have the slim tubes and domes replaced by your hearing healthcare professional approximately every three to six months or when they become stiff, brittle, or discolored.

Clean the outside of the domes at the end of each day with a damp cloth.

You should also clean the slim tubes periodically, with the cleaning pin provided, when you begin to notice debris in and around the tubes.



1. Hold the slim tube in one hand and the hearing system in the other hand.
2. Gently turn the hearing system until it detaches from the slim tube.
3. Use a damp cloth to clean the outside of the slim tube and dome.
4. Remove the dome from the slim tube by pulling gently, before cleaning the slim tube.
5. Using the black cleaning pin provided in the kit, gently insert the cleaning pin where the slim

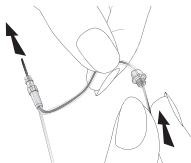

tube attaches to the hearing system and push the pin all the way through the tube.

 *Note: The slim tubes and domes should never be rinsed or submerged in water as water drops may become lodged in the tube, block sound or damage the electrical components of the hearing system.*

6. Once the slim tube has been cleaned, reattach it by gently turning the hearing system onto the slim tube.
7. Reattach the dome to the slim tube by gently pushing it back onto the threading at the end of the tube. You will feel the dome click onto the ridges of the slim tube, and you won't be able to push it any further.

Troubleshooting guide

No sound

Cause	Possible remedy
Not turned on	Turn on
Low/dead battery	Replace battery
Poor battery contact	Consult your hearing healthcare professional
Battery upside down	Insert battery plus (+) side up
Earmolds/slim tubes/ domes blocked with ear wax	Clean earmolds/ domes. See "Cleaning your hearing systems." Use cleaning pin to dislodge ear wax in slim tubes. Consult your hearing healthcare professional
Plugged microphone shield	Consult your hearing healthcare professional

Not loud enough

Cause	Possible remedy
Low volume	Turn up volume; see hearing healthcare professional for models without a manual volume control or if problem persists
Low battery	Replace battery
Earmolds/slim tubes/domes not inserted properly	See "Putting your hearing systems on your ears." Remove and reinsert carefully
Change in hearing	Consult your hearing healthcare professional
Earmolds/slim tubes/domes blocked with ear wax	Clean earmolds. See "Cleaning your hearing systems." Use cleaning pin to dislodge ear wax in slim tubes. Consult your hearing healthcare professional
Plugged microphone shield	Consult your hearing healthcare professional

Intermittent

Cause	Possible remedy
Low battery	Replace battery
Dirty battery contact	Consult your hearing healthcare professional

Two long beeps

Low battery	Replace battery
-------------	-----------------

Whistling

Earmolds/slim tubes/domes not inserted properly	See "Putting your hearing systems on your ears." Remove and reinsert carefully
Hand/clothing near ear	Move hand/clothing away from your ear
Poorly fitting earmolds/slim tubes/domes	Consult your hearing healthcare professional

Not clear, distorted

Cause	Possible remedy
Poorly fitting earmolds/ slim tubes/domes	Consult your hearing healthcare professional
Earmolds/slim tubes/ domes blocked with ear wax	Clean earmolds. See “Cleaning your hearing systems.” Use cleaning pin to dislodge ear wax in slim tubes. Consult your hearing healthcare professional
Low battery	Replace battery
Plugged microphone shield	Consult your hearing healthcare professional

Earmolds/slim tubes/domes falling out of ear

Poorly fitting earmolds/ slim tubes/domes	Consult your hearing healthcare professional
Earmolds/slim tubes/ domes not inserted properly	See “Putting your hear- ing systems on your ears.” Remove and reinsert carefully

Weak on the Telephone

Cause	Possible remedy
Telephone not positioned properly	Move telephone receiver around ear for clearer signal. See "Using the telephone"
Hearing system requires adjustment	Consult your hearing healthcare professional

For any problems not listed in the guide or for service assistance, contact your hearing healthcare professional.

Warning to Hearing System Dispensers (to Comply with the U.S. Food and Drug Administration (FDA) Regulations)

A hearing system dispenser should advise a prospective hearing system user to consult promptly with a licensed physician (preferably an ear specialist) before dispensing a hearing system if the hearing system dispenser determines through inquiry, actual observation, or review of any other available information concerning the prospective user, that the prospective user has any of the following conditions: (i) Visible congenital or traumatic deformity of the ear. (ii) History of active drainage from the ear within the previous 90 days. (iii) History of sudden or rapidly progressive hearing loss within the previous 90 days. (iv) Acute or chronic dizziness. (v) Unilateral hearing loss of sudden or recent onset within the previous 90 days. (vi) Audiometric air-bone gap equal to or greater than 15 decibels at 500 hertz (Hz), 1,000 Hz, and 2,000 Hz. (vii) Visible evidence of significant cerumen accumulation or a foreign body in the ear canal. (viii) Pain or discomfort in the ear. Special care should be exercised in selecting and fitting a hearing system whose maximum sound pressure level exceeds 132 decibels because there may be risk of impairing the remaining hearing of the hearing system user. [This provision is required only for those hearing systems with a maximum sound pressure capability greater than 132 decibels (dB).]

Important notice for prospective hearing system users

Good health practice requires that a person with a hearing loss have a medical evaluation by a licensed physician (preferably a physician who specializes in diseases of the ear) before purchasing a hearing system.

Licensed physicians who specialize in diseases of the ear are often referred to as otolaryngologists, otologists or otorhinolaryngologists. The purpose of medical evaluation is to assure that all medically

treatable conditions that may affect hearing are identified and treated before the hearing system is purchased. Following the medical evaluation, the physician will give you a written statement that states that your hearing loss has been medically evaluated and that you may be considered a candidate for a hearing system. The physician will refer you to an audiologist or a hearing system dispenser, as appropriate, for a hearing system evaluation. The audiologist or hearing system dispenser will conduct a hearing system evaluation to assess your ability to hear with and without a hearing system. The hearing system evaluation will enable the audiologist or dispenser to select and fit a hearing system to your individual needs. If you have reservations about your ability to adapt to amplification, you should inquire about the availability of a trial-rental or purchase-option program. Many hearing system dispensers now offer programs that permit you to wear a hearing system for a period of time for a nominal fee after which you may decide if you want to purchase the hearing system. Federal law restricts the sale of hearing systems to those individuals who have obtained a medical evaluation from a licensed physician. Federal law permits a fully informed adult to sign a waiver statement declining the medical evaluation for religious or personal beliefs that preclude consultation with a physician. The exercise of such a waiver is not in your best health interest and its use is strongly discouraged.

Children with hearing loss

In addition to seeing a physician for a medical evaluation, a child with a hearing loss should be directed to an audiologist for evaluation and rehabilitation since hearing loss may cause problems in language development and the educational and social growth of a child. An audiologist who is qualified by training and experience to assist in the evaluation and rehabilitation of a child with hearing loss is recommended.

Cell phone

Some hearing system users have reported a buzzing sound in their hearing systems when they are using cell phones. According to the ANSI C63.19 standard, the compatibility of a particular hearing system and cell phone can be predicted by adding the rating for the hearing system immunity to the rating for the cell phone emissions. The sum of the hearing system rating (e.g. M2/T2 = 2) and the telephone rating (e.g. M3/T3 = 3) is 5, and any combination that equals 5 will provide 'normal use'. A sum of 6 or greater indicates 'excellent performance'. The equipment performance, measurements, categories and system classifications are based upon the best information available but cannot guarantee that all users will be satisfied.

The rating of this hearing system is at least M2/T2. Your hearing healthcare professional can provide the actual rating for this hearing system.



Note: the performance of the individual hearing systems may vary with individual cell phones. Therefore, please try the hearing system with your cell phone or, if you are purchasing a new phone, please be sure to try it with your hearing system prior to purchase. For additional guidance, please ask your hearing healthcare professional for the booklet entitled "Hearing system compatibility with digital wireless cell phones."

Information and Explanation of Symbols



With the CE symbol, Hansaton confirms that this Hansaton product – including accessories – meets the requirements of the Medical Devices Directive 93/42/EEC, as well as the R&TTE Directive 1999/5/EC on radio and telecommunications transmitters. The numbers after the CE symbol correspond to the code of certified institutions under the above-mentioned directives.



This symbol indicates that it is important for the user to read and take into account the relevant information in this user guide.



This symbol indicates that it is important for the user to pay attention to the relevant warning notices in this user guide.



Important information for handling and product safety.



This symbol indicates that the products described in these user instructions adhere to the requirements for an application part of Type B of EN 60601-1. The surface of the hearing system is specified as applied part of Type B.

Operating Conditions:

This device is designed such that it functions without problems or restrictions if used as intended, unless otherwise noted in these user guides.

0° to 55° Celsius and relative humidity of < 95 % (non condensing).

Transport and Storage Conditions:

Temperature: -20° to +60° Celsius (-4° to +140° Fahrenheit).

Humidity Transportation: Up to 90% (non condensing).

Humidity Storage: 0% to 70%, if not in use.

Atmospheric pressure: 200 hPA to 1500 hPa.



The symbol with the crossed-out garbage bin is to make you aware that this device may not be thrown away as normal household waste. Please dispose of old or unused devices, at waste disposal sites intended for electronic waste, or give your device to your hearing healthcare professional for disposal. Proper disposal protects the environment and health.



91672 CD-SP



Hansaton Akustik GmbH • Sachsenkamp 5 • 20097 Hamburg
Telefon: 040 29 80 11 110 • Fax: 040 29 80 11 850
E-Mail: info@hansaton.com • Internet: www.hansaton.com

 **HANSATON**
hearing & emotions